

The air-conditioning unit uses the latest automotive technology to minimise weight and size while maximising performance.

The modular design allows for easy and effortless installation.

The universal design allows fitment across a wide of vehicles and applications.

The durable all steel chassis offers good protection against the day to day rigours of heavy duty plant environments.

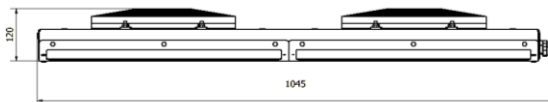
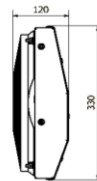
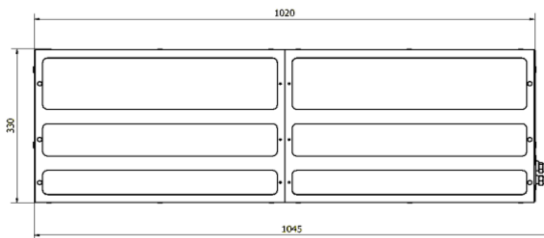
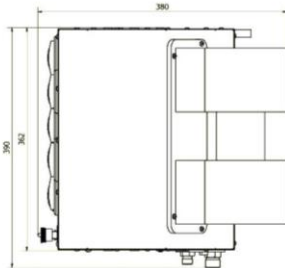
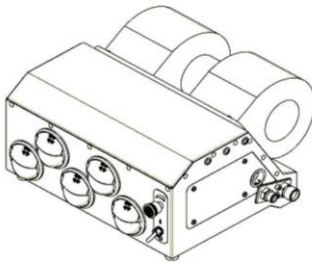
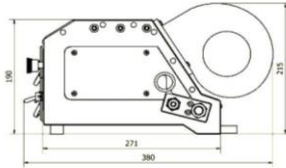
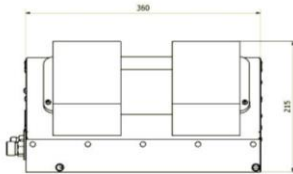

TECHNICAL DATA

VOLTAGE	24	V
COOLING CAPACITY	5,5	kW
AIR FLOW	680	m ³ /h
CURRENT DRAW	40	A
WEIGHT	50	Kg
REFRIGERANT		R134a
BLOWERS	1	EA
FANS	2	EA

ELECTRICAL CONNECTION



24 VOLT SUPPLY

TUBE CONNECTOR

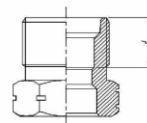

	THREAD	L
SUCT	7/8-14UNF-2A	15,7
DISCH	3/4-16UNF-2A	11
LIQUID	5/8 - 18UNF	9

GENERAL NOTES:

Evaporator and condenser sections are supplied in box.

Hoses are made to order. Compressor is supplied separately